

ADAPTABLE

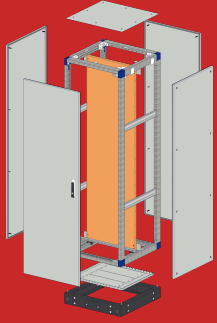

FLEXIBLE

VERSATILE

MODUTEC[®]
Simplifying Panel Building

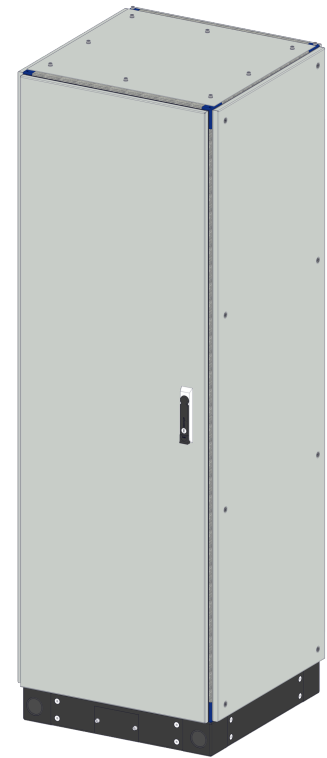

MODBAY

- Modular
- Bayable
- Form 1 Enclosure
- Mounting Plate & Accessories
- Single & Double leaf Door
- Medium & Large Size
- Single & Double Front Configurations

STANDARDIZED

SYSTEMATIZED

HELPS YOU SCALE

Across industries, the drive for energy efficiency and automation has accelerated the demand for VFD panels, soft starter panels, PLC, SCADA & HMI systems, and control & relay panels.

System integrators and panel builders today require solutions that deliver on-time delivery, world-class quality, adaptability to last-minute changes, and ease of assembly even with limited skilled manpower. To meet these evolving needs, Modutec has developed MODBAY — a modular, world-class Form 1 enclosure system offering generous internal space, practical design, and time-saving assembly methods. MODBAY empowers panel builders to execute complex automation and power projects with higher precision and efficiency.

Design Features and Accessories

- Adjustable punched & pierced profile structure for rigidity & versatility.
- Removable side doors and top covers that are double bent in edges for additional strength.
- Lifting eye bolts with load sharing in XYZ axis with special bracket.
- Baying kit for (attaching adjacent enclosure).
- Robust three-point locking system offering secure closure with modern aesthetics.
- Provision for louvers with filters, fans, limit switches, and other mounting accessories.
- Hinged door with 120° opening and reversible orientation (Left ↔ Right) for flexible installation.
- Door stiffener with punched holes for convenient mounting of door-mounted components.
- Side covers pair consists of 1 LHS & 1 RHS cover. These are interchangeable.

Supply Includes:

- Frame work is made of 4 Bend Cross bar 2mm thick and punched & Pierced throughout the length of the profile at alternating intervals of 30 mm. The pierced holes are tapped to M6.
- These cross bars provide structural rigidity and flexibility to the enclosure skeleton
- Enclosure with 120 degree hinged door(s), with door reversible feature of LHS to RHS & versatile stiffener.
- Gland plate at bottom and bolted cover on top.
- Mounting plate - full or partial.
- Accessories for inner door if required.
- Customization if and as required.
- 4 Nos eye bolt for lifting.

B X 0 6 0 1 8 0 4 2

Type	Width	Height	Depth
1 - With Mounting Plate, Front Hinged Door And Rear Bolted Cover	600	1800	420
2 - With Mounting Plate, Front Hinged Door And Rear Hinged Door	780	1980	480
3 - With Front Hinged Door & Rear Bolted Cover, Without Mounting Plate	1020	2220	600
4 - With Front Hinged Door & Rear Hinged Door, Without Mounting Plate	1200		780
5 - Double Front With 2 Mounting Plates, Front And Rear Hinged Doors			

Accessories:

- Door stay
- Toughened Glass Door of required size
- Base Plinth in 100 mm version
- Slotted Din Rails on Door stiffener Drawing
- Pocket (Sheet steel or Plastic) Cam Lock with external Lock
- Limit switch for door LED light fitting (100 - 240 V AC)

Material Specification:

Item	Material	Thickness(mm)	Surface finish
Profiles	ALUZINC	2	Without Powder Coating
Hinged Door	CRCA	2	Powder coated Structure Finish
Bolted Cover	CRCA	1.6	Powder coated Structure Finish
Side Cover	CRCA	1.6	Powder coated Structure Finish
Mounting Plate	ALUZINC	2	Without Powder Coating
Gland Plate	CRCA	2	Powder coated Structure Finish

MODBAY

With Single Door - IP 54

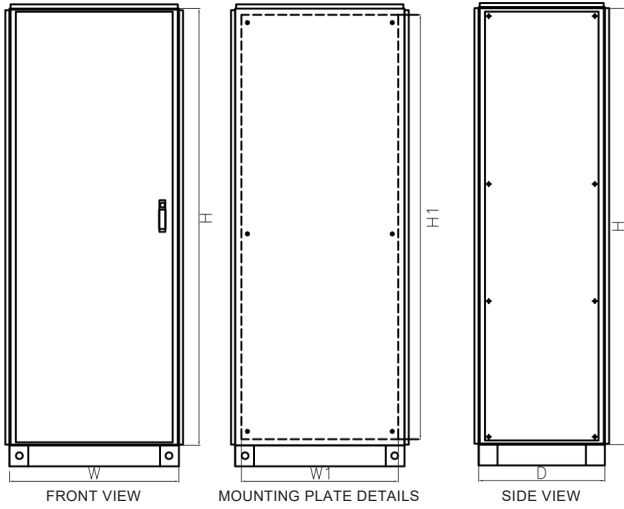

Sl.No	CATALOG NUMBER	ENCLOSURE			MOUNTING PLATE	
		WIDTH	HEIGHT	DEPTH	W1	H1
1	BX06018042	600	1800	420	510	1710
2	BX07818042	780	1800	420	690	1710
3	BX06018048	600	1800	480	510	1710
4	BX07818048	780	1800	480	690	1710
5	BX06019842	600	1980	420	510	1890
6	BX07819842	780	1980	420	690	1890
7	BX06019848	600	1980	480	510	1890
8	BX07819848	780	1980	480	690	1890
9	BX06019860	600	1980	600	510	1890
10	BX07819860	780	1980	600	690	1890
11	BX06019878	600	1980	780	510	1890
12	BX07819878	780	1980	780	690	1890
13	BX06022260	600	2220	600	510	2130
14	BX07822260	780	2220	600	690	2130
15	BX06022278	600	2220	780	510	2130
16	BX07822278	780	2220	780	690	2130

MODBAY

With Double Door - IP 54

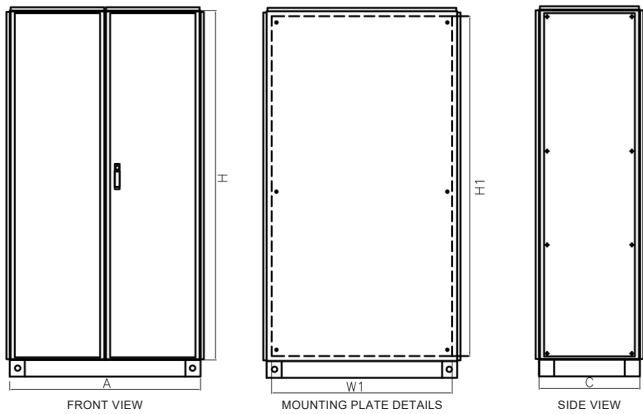

Sl.No	CATALOG NUMBER	ENCLOSURE			MOUNTING PLATE	
		WIDTH	HEIGHT	DEPTH	W1	H1
1	BX10218042	1020	1800	420	930	1710
2	BX12018042	1200	1800	420	1110	1710
3	BX10218048	1020	1800	480	930	1710
4	BX12018048	1200	1800	480	1110	1710
5	BX10219842	1020	1980	420	930	1890
6	BX12019842	1200	1980	420	1110	1890
7	BX10219848	1020	1980	480	930	1890
8	BX12019848	1200	1980	480	1110	1890
9	BX10219860	1020	1980	600	930	1890
10	BX12019860	1200	1980	600	1110	1890
11	BX10219878	1020	1980	780	930	1890
12	BX12019878	1200	1980	780	1110	1890
13	BX10222060	1020	2220	600	930	2130
14	BX12022260	1200	2220	600	1110	2130
15	BX10222278	1020	2220	780	930	2130
16	BX12022278	1200	2220	780	1110	2130

* All dimensions are in mm

MODBAY

BASE / PLINTH

For increased floor clearance or cable entry convenience, MODBAY is available with a height of 100mm Plinth of sheet steel with 4 corner pieces, 4 cover cap & removable width & depth cover plates.

Surface finish: Matte black color with powder coating.

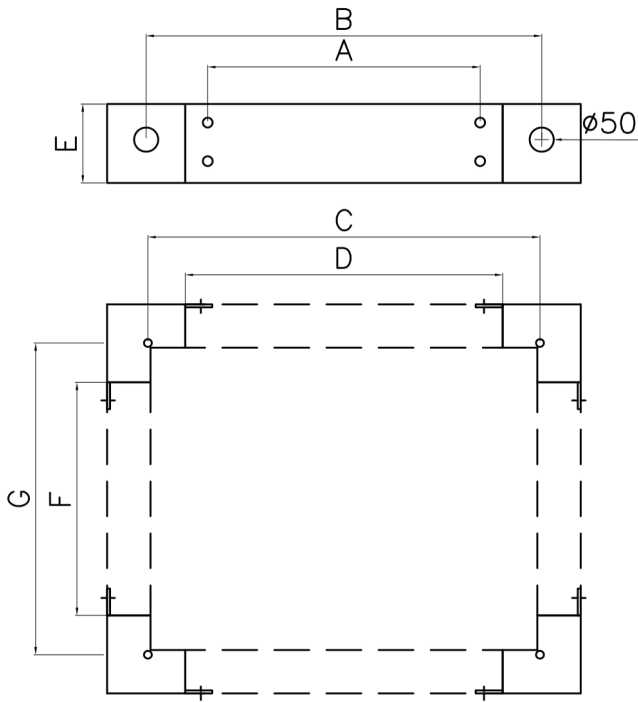

SI.No	CATALOG NUMBER	DIMENSION	
		WIDTH	DEPTH
1	MODUPLX060042010G	600	420
2	MODUPLX078042010G	780	420
3	MODUPLX102042010G	1020	420
4	MODUPLX120042010G	1200	420
5	MODUPLX060048010G	600	480
6	MODUPLX078048010G	780	480
7	MODUPLX102048010G	1020	480
8	MODUPLX120048010G	1200	480
9	MODUPLX060060010G	600	600
10	MODUPLX078060010G	780	600
11	MODUPLX102060010G	1020	600
12	MODUPLX120060010G	1200	600
13	MODUPLX060078010G	600	780
14	MODUPLX078078010G	780	780
15	MODUPLX102078010G	1020	780
16	MODUPLX120078010G	1200	780

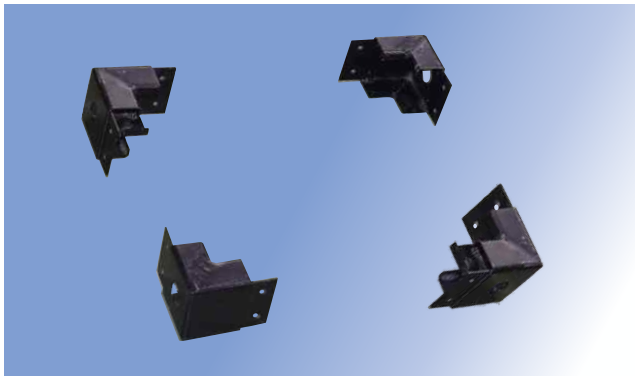

SI no	PLINTH		A	B	C	D	E	F	G
	HEIGHT	DEPTH							
1	600	420	380	500	510	420	100	240	330
2	780	420	560	680	690	600	100	240	330
3	1020	420	800	920	930	840	100	240	330
4	1200	420	980	1100	1110	1020	100	240	330
5	600	480	380	500	510	420	100	300	390
7	780	480	560	680	690	600	100	300	390
8	1020	480	800	920	930	840	100	300	390
9	1200	480	980	1100	1110	1020	100	300	390
10	600	600	380	500	510	420	100	420	510
12	780	600	560	680	690	600	100	420	510
13	1020	600	800	920	930	840	100	420	510
14	1200	600	980	1100	1110	1020	100	420	510
15	600	780	380	500	510	420	100	540	690
17	780	780	560	680	690	600	100	640	690
18	1020	780	800	920	930	840	100	640	690
19	1200	780	980	1100	1110	1020	100	640	690

* All dimensions are in mm

BAYING KIT FOR MODBAY

Consists of joiner members & hardware as per picture below in L type & straight type to Cat No MODBAYKLT XXXXXXXX or MODBAYKST XXXXXXXX

There are 2 mm sheet steel, zinc plated, passivated...



L TYPE

SI.No	ENCLOSURE		CATALOG NUMBER FOR L TYPE BAYING KIT
	HEIGHT	DEPTH	
1	1800	420	MODBAYKLT180042X
2	1980	420	MODBAYKLT198042X
3	2220	420	MODBAYKLT222042X
4	1800	480	MODBAYKLT180048X
5	1980	480	MODBAYKLT198048X
6	2220	480	MODBAYKLT222048X
7	1800	600	MODBAYKLT180060X
8	1980	600	MODBAYKLT198060X
9	2220	600	MODBAYKLT222060X
10	1800	780	MODBAYKLT180078X
11	1980	780	MODBAYKLT198078X
12	2220	780	MODBAYKLT222078X



STRAIGHT TYPE

SI.No	ENCLOSURE		CATALOG NUMBER FOR STRAIGHT TYPE
	HEIGHT	DEPTH	
1	1800	420	MODBAYKST180042X
2	1980	420	MODBAYKST198042X
3	2220	420	MODBAYKST222042X
4	1800	480	MODBAYKST180048X
5	1980	480	MODBAYKST198048X
6	2220	480	MODBAYKST222048X
7	1800	600	MODBAYKST180060X
8	1980	600	MODBAYKST198060X
9	2220	600	MODBAYKST222060X
10	1800	780	MODBAYKST180078X
11	1980	780	MODBAYKST198078X
12	2220	780	MODBAYKST222078X

MOUNTING PLATE INFILL

For a continuous mounting surface in MODBAY when bayed, this closes the gap. These are of 2 mm galvanized sheet steel.

SI. No	Mounting Plate inFill	CATALOG NUMBER
	HEIGHT	
1	1800	MODUMPF180XXX10G
2	1980	MODUMPF198XXX10G
3	2220	MODUMPF222XXX10G

OUR GLOBAL SPREAD



AUSTRALIA

NEW
ZEALAND

SOUTH EAST
ASIA

MIDDLE EAST
& AFRICA

INDIA

EUROPE

Modutec Ready Panels Pvt Ltd

No. 4, Survey No 105 , K.Ashwath Industrial Layout, Uttari Road
Kaggalipura, Off Kanakpura Road, Bangalore - 560116, India

 +91 99014 59624, +91 98450 40837

 sales@modutec.net, modular@modutec.net

 www.modutec.net



Established 1988
Uniting Panel Builders

Proud Member of

Control Panel and Switchgear Manufacturers' Association

